

# PRIME OPPORTUNITY

## 0.92± ACRE COMMERCIAL SITE

### FOR SALE

1509 DIPLOMAT PARKWAY W, CAPE CORAL, FL 33993



- PRICE:** \$375,000 @ \$9.38 PSF or \$407,600/Acre
- SIZE:** 0.92± Acres (40,000± SF)
- DIMENSIONS:** 320' Frontage x 125'
- LOCATION:** Just off the intersection of Diplomat Parkway W & Chiquita Boulevard
- ZONING:** C - Commercial (City of Cape Coral) [Click here for uses](#)
- F.L.U.:** CP - Commercial Professional
- UTILITIES:** Well & Septic
- RE TAXES:** \$1,727.06 (2022)
- PARCEL ID:** 34-43-23-C4-02924.B370

#### COMMERCIAL LOT

Prime commercial site just one lot east of the intersection of Diplomat Parkway W and Chiquita Blvd S. With 375' of frontage on Diplomat Parkway, this highly visible and accessible property offers a versatile opportunity for any commercial user. Commercial zoning allows various retail and office uses making it ideal for businesses looking to serve a large trade area. Take advantage of its proximity to the Pine Island Road Corridor, Burnt Store Road, shopping centers, schools, Coral Oaks Golf Course, and upcoming developments.

**CONTACT**  
**FRED KERMANI, CCIM, AIA**  
Partner  
239.659.4960  
[Fred.Kermani@CREconsultants.com](mailto:Fred.Kermani@CREconsultants.com)  
[www.CREconsultants.com/FredKermani](http://www.CREconsultants.com/FredKermani)

12140 Carissa Commerce Ct, Suite 102  
Fort Myers, FL 33966  
1100 Fifth Ave. S, Suite 404  
Naples, FL 34102

The information contained herein was obtained from sources believed reliable. CRE Consultants makes no guarantees, warranties or representations as to the completeness or accuracy thereof, and is subject to errors, omissions, change of price or conditions prior to sale or lease, or withdrawal without notice. 07/21/23



# PRIME OPPORTUNITY

## 0.92 ± ACRE COMMERCIAL SITE

### FOR SALE

1509 DIPLOMAT PARKWAY W, CAPE CORAL, FL 33993

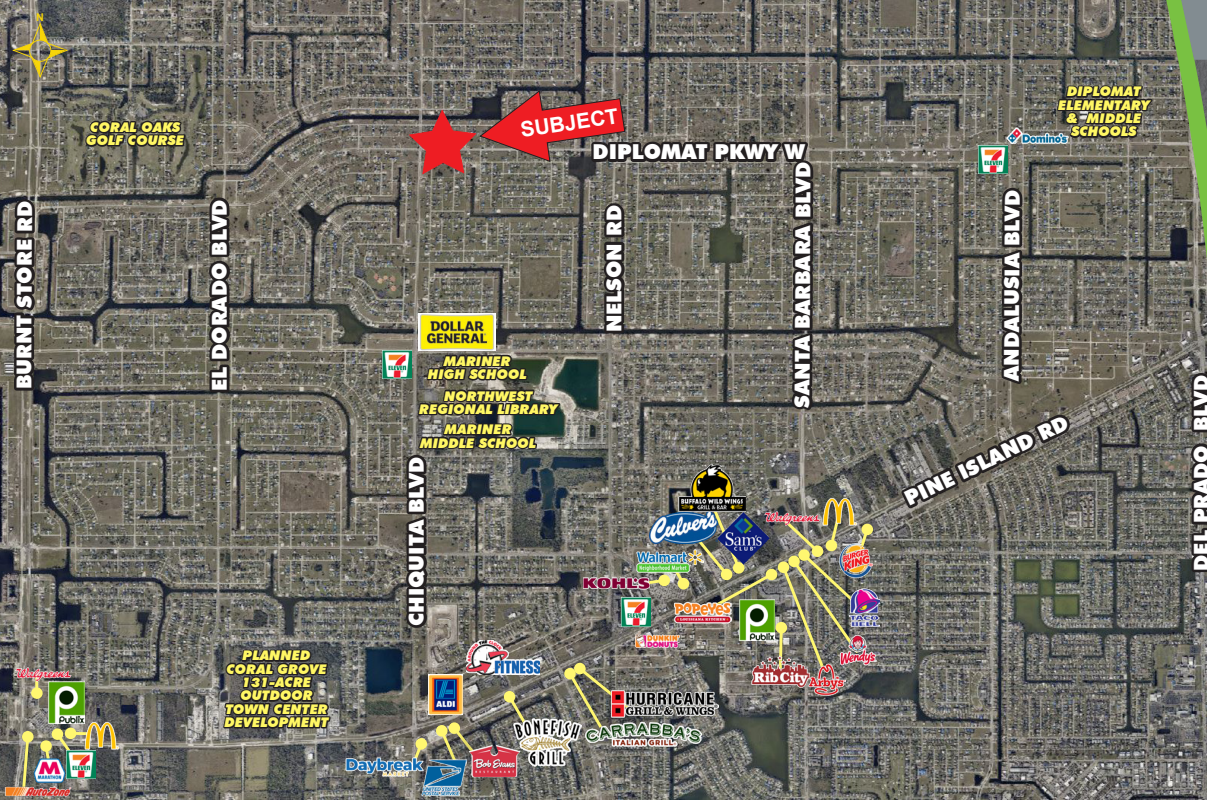

### HIGHLIGHTS

- 375' frontage on Diplomat Pkwy ensures exceptional exposure
- Zoned for various retail and office uses, perfect for a large trade area



### CONTACT

**FRED KERMANI, CCIM, AIA**

**Partner**

239.659.4960

[Fred.Kermani@CREconsultants.com](mailto:Fred.Kermani@CREconsultants.com)

[www.CREconsultants.com/FredKermani](http://www.CREconsultants.com/FredKermani)

2023 DEMOGRAPHICS	1 MILE	3 MILES	5 MILES
EST. POPULATION	6,261	39,596	102,131
EST. HOUSEHOLDS	2,118	13,229	36,867
EST. MEDIAN HOUSEHOLD INCOME	\$81,318	\$77,108	\$73,886
TRAFFIC COUNTS (2022)	9,700 AADT		

The information contained herein was obtained from sources believed reliable. CRE Consultants makes no guarantees, warranties or representations as to the completeness or accuracy thereof, and is subject to errors, omissions, change of price or conditions prior to sale or lease, or withdrawal without notice.