

# PRIME US 41 LOCATION

## OFFICE/RETAIL/MEDICAL SPACE



# FOR LEASE

5035 TAMIAMI TRAIL E, NAPLES, FL 34113



SUITE	SIZE (SF)	LEASE RATE (PSF)	MONTHLY BASE RENT	MONTHLY SALES TAX	MONTHLY TOTAL
H2	902	\$15.00	\$1,127.50	\$73.29	\$1,200.79

**LEASE RATE:** \$15.00 PSF Modified Gross (Tenant to pay Electric, Phone, Internet)

**SIZE:** 902± SF

**LOCATION:** On Tamiami Trail E (US 41), just SE of Rattlesnake Hammock Road

**YEAR BUILT:** 1986

**ZONING:** C4 - Commercial (Collier County)

### THE VILLAGE FALLS PROFESSIONAL COMPLEX

This first-floor unit boasts a private courtyard entrance and plenty of parking. C4 zoning accommodates a wide range of businesses, including office, medical, retail, and more. Situated in The Village Falls, a professional complex on Tamiami Trail E (US 41), enjoys a strategic location opposite Publix anchored Shops at Hammock Cove, various dining options, and banks. Easy and convenient access to US 41, just 6± miles to downtown Naples and 5th Avenue S.

### CONTACT

**DAVE WALLACE, CCIM, SIOR**  
 Senior Vice President  
 239.659.1447 x218  
 dave.wallace@creconsultants.com

**DAVID WALLACE**  
 Senior Associate  
 239.659.1447 x223  
 david.wallace@creconsultants.com

12140 Carissa Commerce Ct, Suite 102  
 Fort Myers, FL 33966  
 1100 Fifth Ave. S, Suite 404  
 Naples, FL 34102

The information contained herein was obtained from sources believed reliable. CRE Consultants makes no guarantees, warranties or representations as to the completeness or accuracy thereof, and is subject to errors, omissions, change of price or conditions prior to sale or lease, or withdrawal without notice. 10/12/23

# PRIME US 41 LOCATION

## OFFICE/RETAIL/MEDICAL SPACE

### FOR LEASE

5035 TAMIAMI TRAIL E, NAPLES, FL 34113

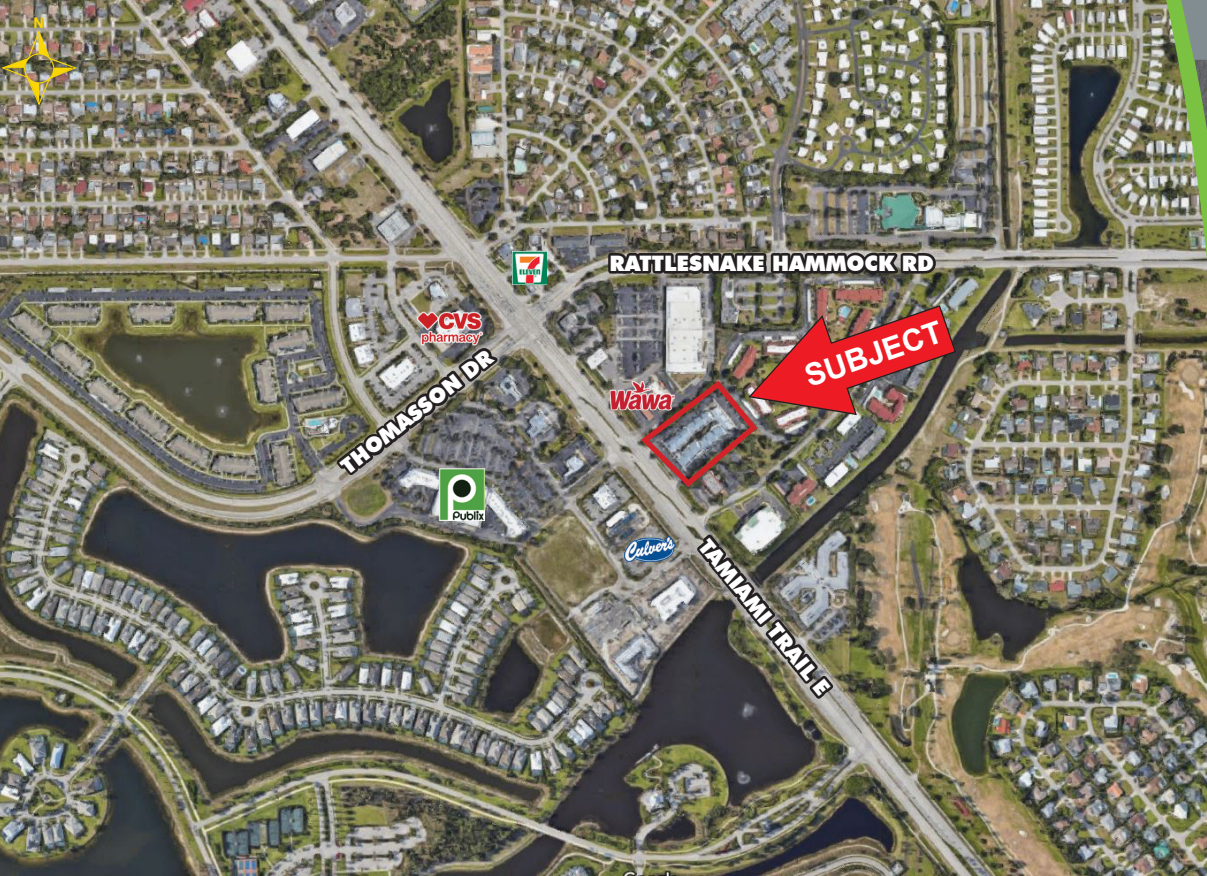

### HIGHLIGHTS

- First floor unit
- Private entrance
- Can be used for Medical/ Retail/Office
- Easy access off US 41

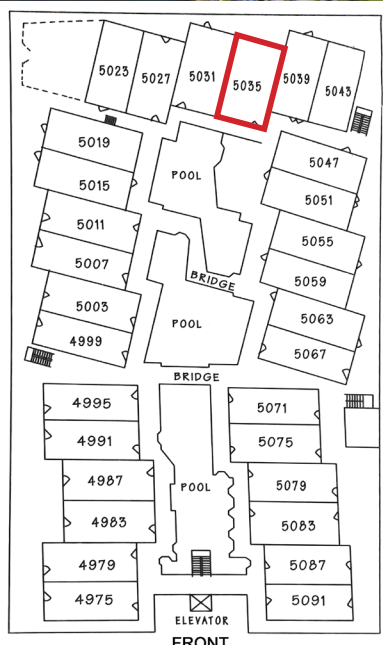

### CONTACT

**DAVE WALLACE, CCIM, SIOR**  
Senior Vice President  
239.659.1447 x218  
[dave.wallace@creconsultants.com](mailto:dave.wallace@creconsultants.com)

**DAVID WALLACE**  
Senior Associate  
239.659.1447 x223  
[david.wallace@creconsultants.com](mailto:david.wallace@creconsultants.com)

2023 DEMOGRAPHICS	1 MILE	3 MILES	5 MILES
EST. POPULATION	6,035	48,885	99,106
EST. HOUSEHOLDS	2,800	21,739	45,849
EST. MEDIAN HOUSEHOLD INCOME	\$64,111	\$63,988	\$67,260
TRAFFIC COUNTS (2022)	45,000 AADT		

The information contained herein was obtained from sources believed reliable. CRE Consultants makes no guarantees, warranties or representations as to the completeness or accuracy thereof, and is subject to errors, omissions, change of price or conditions prior to sale or lease, or withdrawal without notice.